

This set of instructions was first published in 2003 as part of a 3-day technique class led by Caryl Bryer Fallert-Gentry.

FINISHING

BINDING • HANGING SLEEVE • LABEL • SIGNATURE



In this lesson, we will be making a two color, pieced binding.

Naturally, you can simplify your quilt by using a single color binding.

BACK

NEXT

Cut strips of fabric for your binding and hanging sleeves 1-2" longer than the width of your quilt

Bottom Casing : 3" x 26"

Top Casing (hanging sleeve):
8" x 26"

Glacier Blue Binding: 2" x 26+" (5 cm x 65+cm)

Glacier Blue Binding: 2" x 26+" (5 cm x 65+cm)

Glacier Blue Binding: 2" x 26+" (5 cm x 65+cm)

Ombre Stripe binding: 2" x 26+" (5 cm x 65+cm) Cut on cross grain.

Ombre Stripe Binding: 2" x 44" (5cm x 112cm) Cut on cross grain, full width of fabric.



Lay your top and bottom casing strips, right side down, along the top and bottom of your quilt.

BACK

NEXT

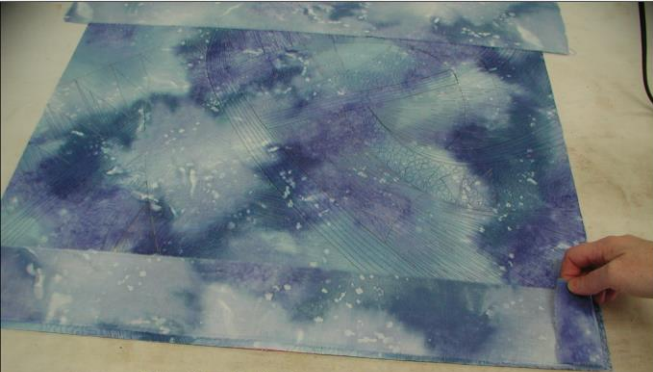

Fold back the ends of the bottom casing, so that the fold is $\frac{1}{4}$ " (12mm) from the right and left sides of the quilt.

BACK

NEXT



Iron the fold in place.

BACK

NEXT



Fold back and iron the top casing so the folds are 1" from the sides.

Trim the folded
edges so they are
even on both
ends.

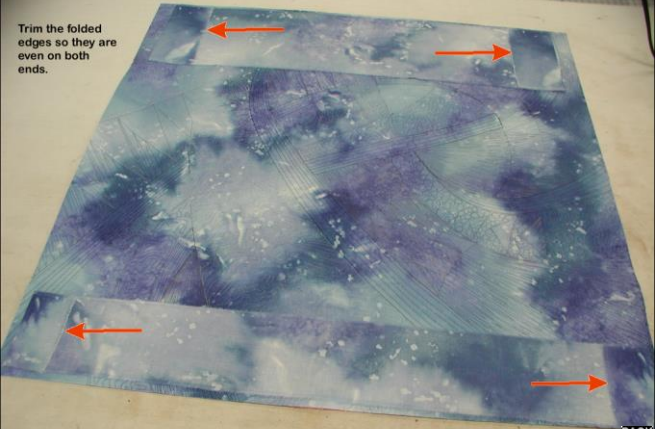

BACK

NEXT



BACK

NEXT

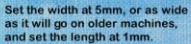



**Select thread in a
matching color, and stitch
over the raw edge.**

BACK

NEXT



A very fine (light weight) thread like "The Bottom Line" by Superior or "Metrolene" by Mettler is recommended.

BACK

NEXT

Fold your casings in half, matching the raw edges,...

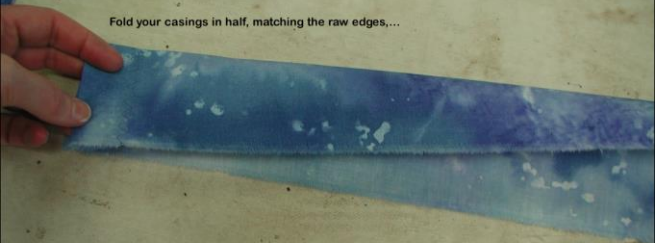

BACK

NEXT

and iron.



BACK

NEXT

Make a label for your quilt. This one was printed on an ink jet printer. You can use presoaked fabric sheets for this, or you can make your own fabric sheets with Bubble Jet Set fabric soak.

SOARING COMPLIMENTS

2003 • 24" x 24"

Fabric: 100% cotton • Batting: 80% cotton/20% polyester • Machine pieced, appliqued and quilted
Caryl Bryer Fallert • PO Box 945 • Oswego, IL 60543 • USA • (630) 564-1177 • www.bryerpatch.com



SOARING COMPLIMENTS

2003 • 24" x 24"

Fabric: 100% cotton • Batting: 80% cotton/20% polyester • Machine pieced, appliqued and quilted
Caryl Bryer Fallert • PO Box 945 • Oswego, IL 60543 • USA • (630) 564-1177 • www.bryerpatch.com

You can place your label on either the top or bottom casing.
Here we are placing it in the center of the top casing.

This label was ironed to "Wonder-Under",
so it can be fused in place.

SOARING COME

2003 • 24

Fabric: 100% cotton • Batting: 80% cotton/20% polyester •
Caryl Bryer Fallert • PO Box 945 • Oswego, IL 60543 • USA • (630) 681-1111



BACK

NEXT

Set your machine for zigzag

Stitch length: .5mm

Stitch width 1.6mm



BACK

NEXT

SOARING COMPLIMENTS

2003 • 24" x 24"

Fabric: 100% cotton • Batting: 80% cotton/20% polyester • Machine pieced, appliqued and quilted
Caryl Bryer Fallert • PO Box 945 • Oswego, IL 60543 • USA • (630) 554-1177 • www.bryerpatch.com

Finish the raw edge with thread that matches the label or the casing.
Once again, this is a good place to use very fine (lightweight) thread.



Set aside your casings while we make
the right and left side bindings.



[BACK](#)

[NEXT](#)



←
Your right
binding will
be made
from the dark
"Ombre
Stripe"
fabric.



BACK

NEXT

Your left
binding will be
made from the

same fabric as
your quilt back
and casings.



BACK

NEXT



Fold the 2" (5cm) strip in half, so the raw edges match, ...



BACK

NEXT

and iron.





Lay the binding strip along the right edge of the quilt with the raw edges to the outside.

← raw edges

BACK

NEXT



Use masking tape along the fold to hold it in place. Naturally you can also use pins. However, the masking tape keeps the edge flat, and helps prevent stretching along the edge.

BACK

NEXT

left side



left side

Fold and iron a Glacier Blue binding strip for the left side of the quilt.

Glacier Blue binding strip, folded and ironed.

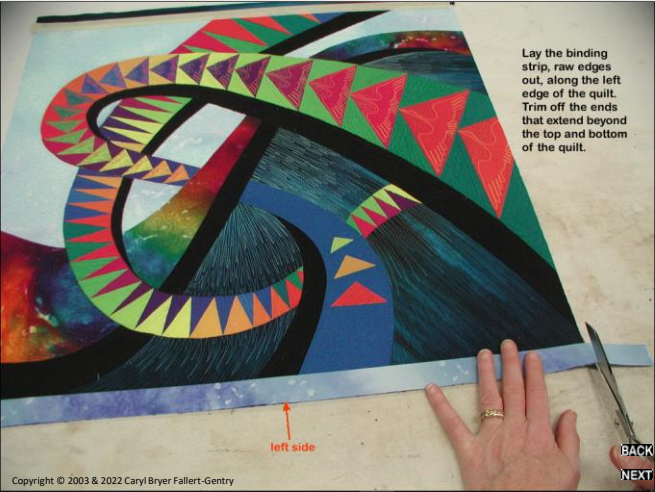

Lay the binding strip, raw edges out, along the left edge of the quilt. Trim off the ends that extend beyond the top and bottom of the quilt.

left side

Use masking
tape along
the fold, to
hold the
binding strip
in place.

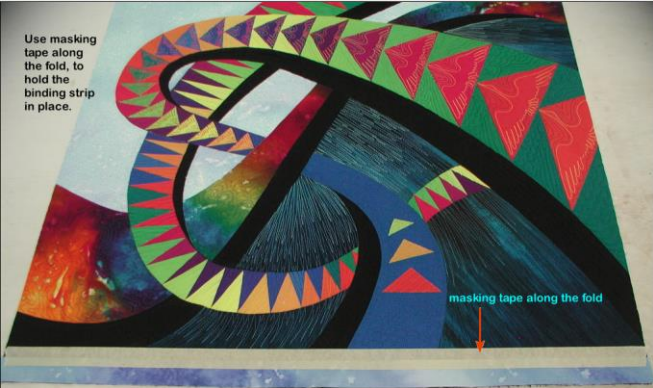

BACK

NEXT

With a walking foot, stitch slightly less than a quarter inch (ideally about 4-5mm or 3/8 inch) from the raw edges.

edge of fabric

quarter inch mark

BACK

NEXT



Iron your binding toward the outside edge.

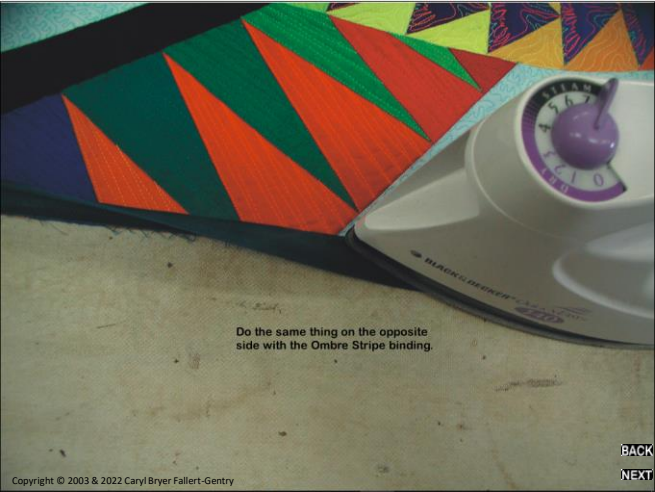

Do the same thing on the opposite side with the Ombre Stripe binding.

BACK

NEXT



Turn the quilt face down, and iron the binding over the seam allowance, toward the back.

BACK

NEXT



Run a bead of glue along the seam allowance.

BACK

NEXT



BACK

NEXT

Carefully place the fold about 1/8" (2mm) beyond the stitching line. Make the space between the fold and the stitching line as even as possible.

When the binding strip is exactly where you want it, iron it again to set the glue.

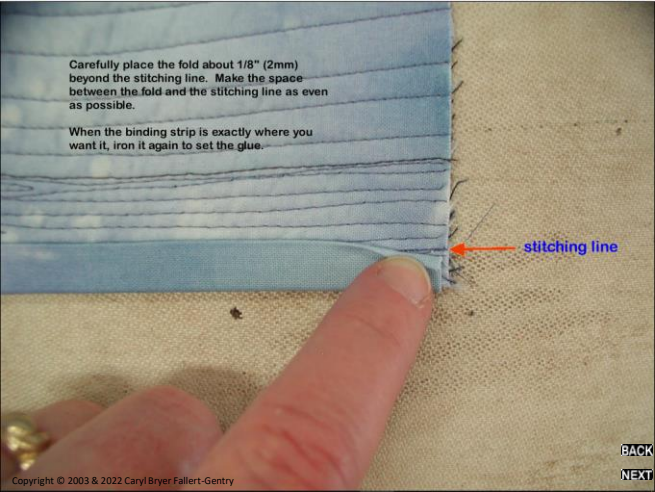

stitching line

[BACK](#)

[NEXT](#)

Here's what it
looks like now
on the back...



and this is
what it looks
like on the
front.

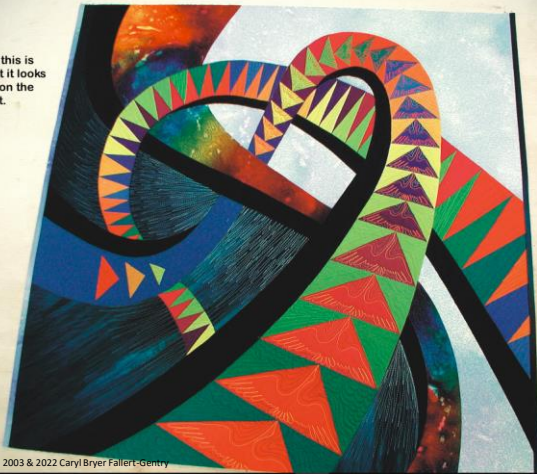

Line up the raw edges of the top casing with the top edge of the quilt, and tape along the fold.

SOARING COMPLIMENTS

2003 • 24" x 24"

Fabric: 100% cotton • Binding: 80% cotton/20% polyester • Machine pieced, applique and quilted
Caryl Bryer Fallert • PO Box 245 • Pottsville, PA 17855 • (610) 336-1177 • www.bryerquilt.com

BACK

NEXT

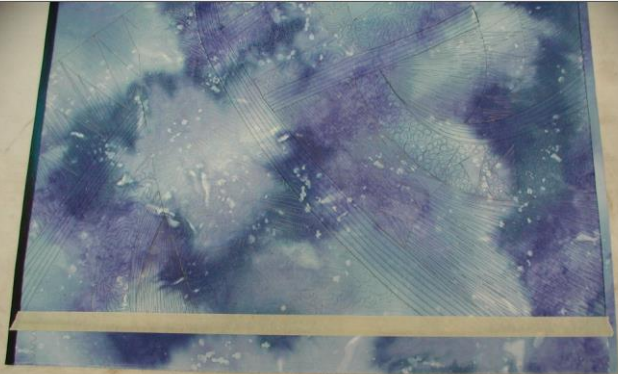

**Line up the raw edges of the bottom casing
with the bottom edge, and tape along the fold.**

BACK

NEXT



You will be piecing the bottom binding. Sew together one strip of Glacier Blue, and one strip of the Ombre Stripe binding with a standard quarter inch (6mm) seam and press open.

[BACK](#)

[NEXT](#)



Lay your binding strip next to the bottom edge of the quilt, and line up these seams. You'll notice that the dark fabric in the binding lines up with the light fabric in the quilt, and the light part of the binding lines up with the dark side of the quilt.

A close-up photograph showing a hand holding a pair of silver scissors, trimming a piece of black fabric that is part of a quilt. The quilt features a colorful geometric pattern with red, green, and blue triangles and a dark blue textured section. The background is a light-colored, slightly textured surface.

Trim off the excess fabric
1" (2.5cm) beyond the
right edge of the quilt...

[BACK](#)

[NEXT](#)

and the left edge
of the quilt.

[BACK](#)

[NEXT](#)

A close-up photograph showing a person's hand holding a white steam iron. The iron is being used to press a blue, patterned fabric strip onto a book cover. The book cover features a vibrant geometric design with red, green, and blue triangles and a central blue textured cone. The iron's temperature dial is visible, set to a medium heat level. The background is a light-colored, slightly textured surface.

Fold and iron your
binding strip.

[BACK](#)

[NEXT](#)



Line up your
seams...



and pin in place. Then tape
along the fold.

BACK

NEXT

At the top of the quilt, the seam in the quilt intersects the edge at an angle.



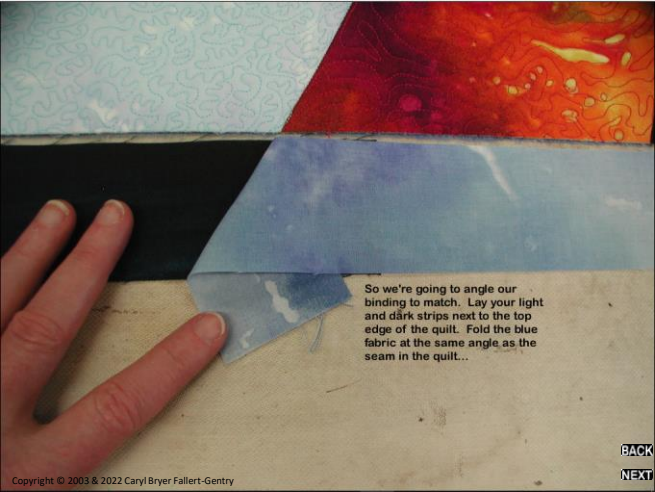

So we're going to angle our binding to match. Lay your light and dark strips next to the top edge of the quilt. Fold the blue fabric at the same angle as the seam in the quilt...

BACK

NEXT

and iron.



[BACK](#)

[NEXT](#)

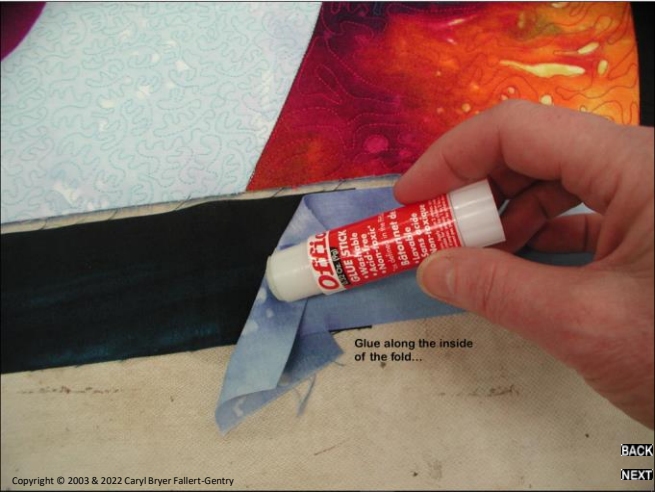

Glue along the inside
of the fold...

BACK

NEXT



and iron.

BACK

NEXT



Fold back and
stitch in the
crease.

[BACK](#)

[NEXT](#)

Trim your seam allowance, ...

BACK

NEXT



open your seam, and iron. Even though the seam was glued, it will pull apart very easily.



Fold and iron your
binding strip.



BACK

NEXT

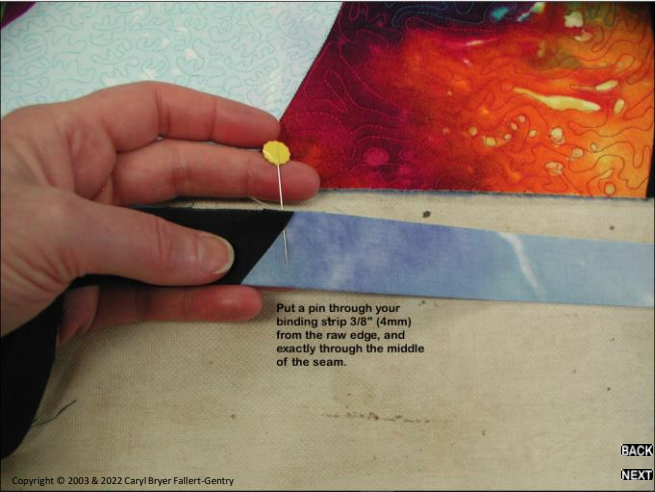

Put a pin through your binding strip 3/8" (4mm) from the raw edge, and exactly through the middle of the seam.

BACK

NEXT

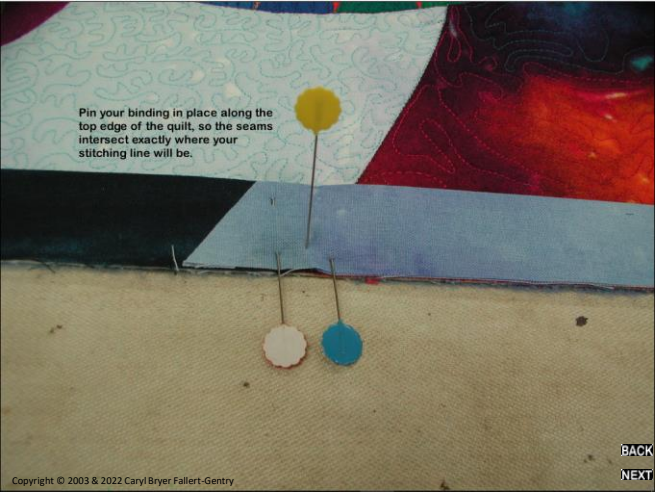

Pin your binding in place along the top edge of the quilt, so the seams intersect exactly where your stitching line will be.

BACK

NEXT



seamline in quilt

BACK

NEXT



seamline in
underside of
binding

BACK

NEXT

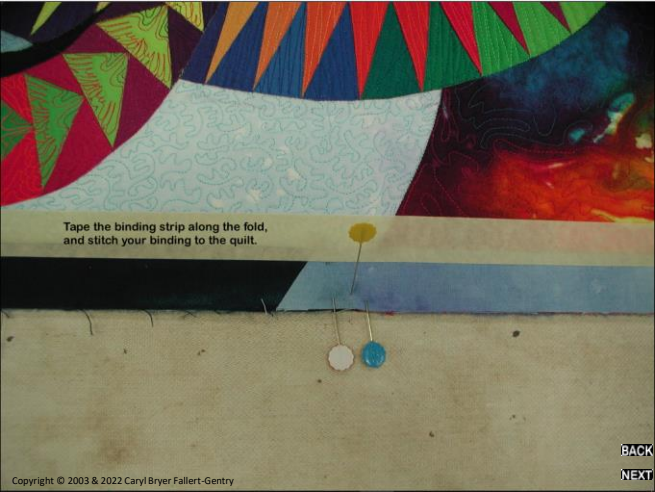

Tape the binding strip along the fold,
and stitch your binding to the quilt.



Start sewing at the point you marked with the pin, where the seams intersect, so none of the seams that need to meet can shift.

Sew to one end, then start at the seam again and sew to the other end.

[BACK](#)

[NEXT](#)



Iron your top binding...

BACK

NEXT

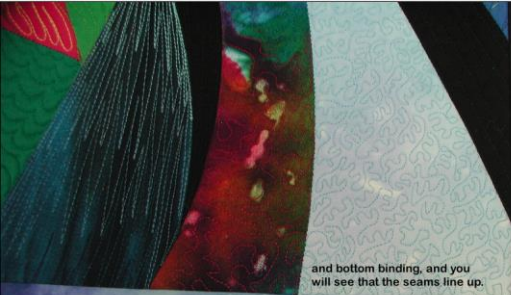

and bottom binding, and you
will see that the seams line up.



Iron your binding to the back
side of the quilt.

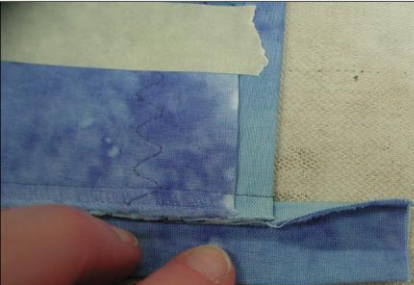

Here is your corner, with the
extra 1" (2.5cm) extension
beyond the edge.

BACK

NEXT



Put a smudge
of glue on that
corner.

Office

0.32 Oz. (9g)

GLUE STICK

• Washable

• Acid-free

• Non-toxic

[BACK](#)

[NEXT](#)

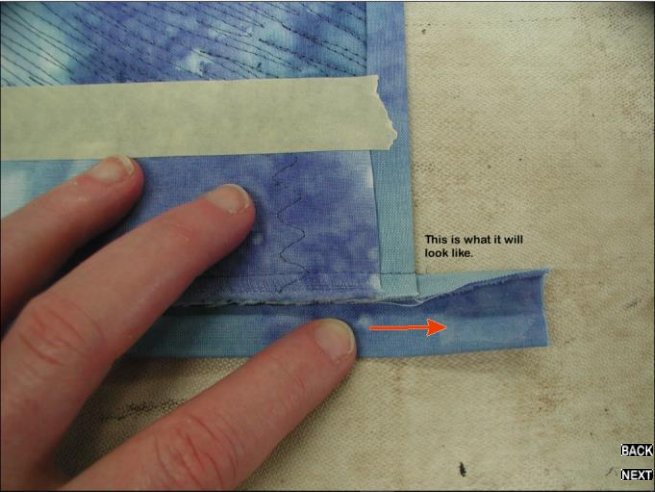

This is what it will
look like.

BACK

NEXT

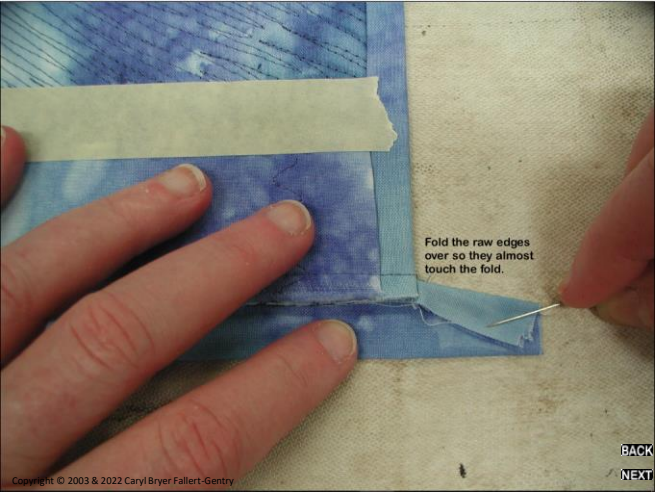

Fold the raw edges
over so they almost
touch the fold.

BACK

NEXT

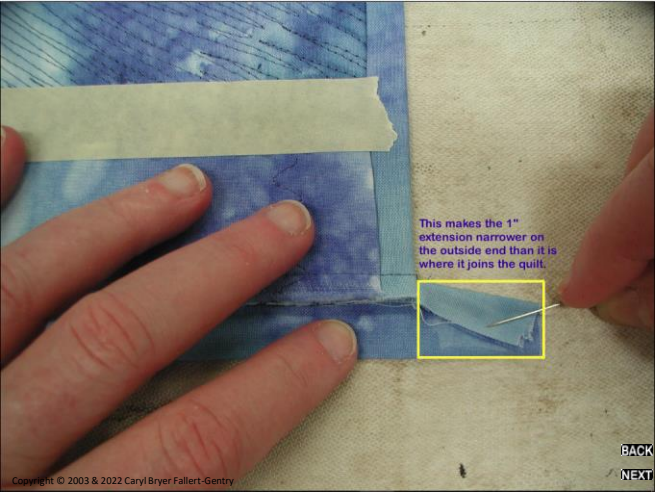

This makes the 1"
extension narrower on
the outside end than it is
where it joins the quilt.



BACK

NEXT

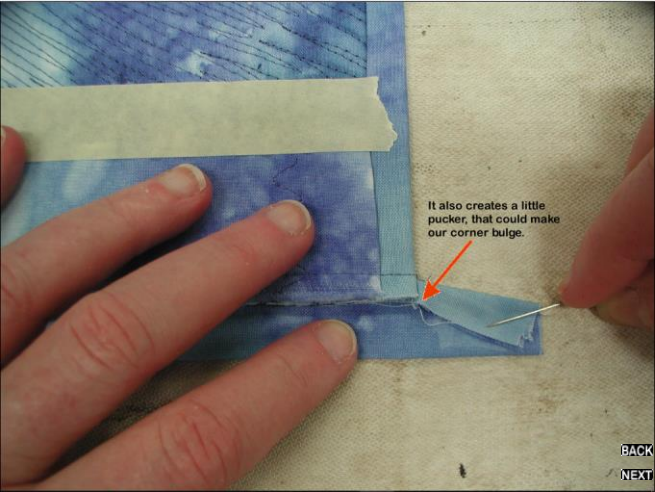

It also creates a little
pucker, that could make
our corner bulge.

BACK

NEXT

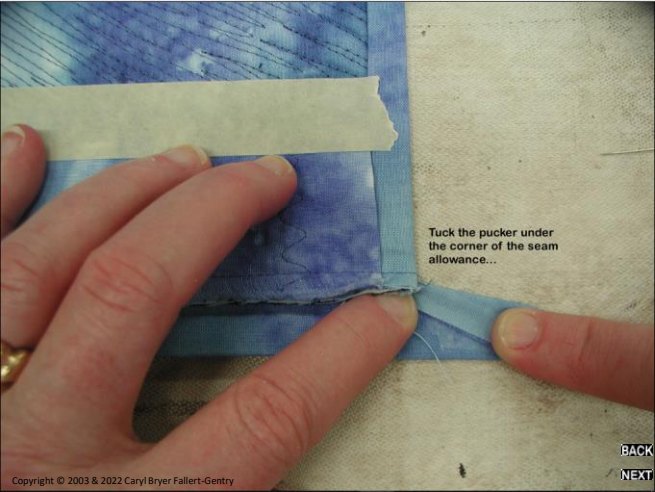

Tuck the pucker under
the corner of the seam
allowance...

[BACK](#)

[NEXT](#)



and iron.

BACK

NEXT



This is what it will
look like after it has
been ironed.

BACK

NEXT



Apply more glue,...

Offic
1.2 Oz. (9g)
GLUE STICK
Washable
Acid-free
Non-toxic

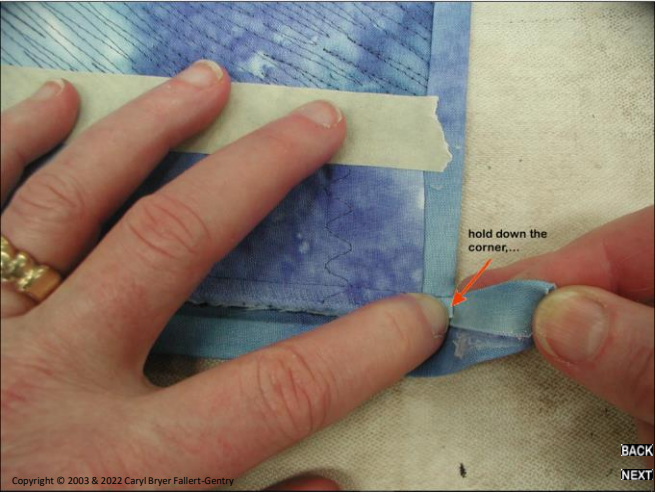

hold down the
corner,...

BACK

NEXT



and fold back the
1" extension.

BACK

NEXT

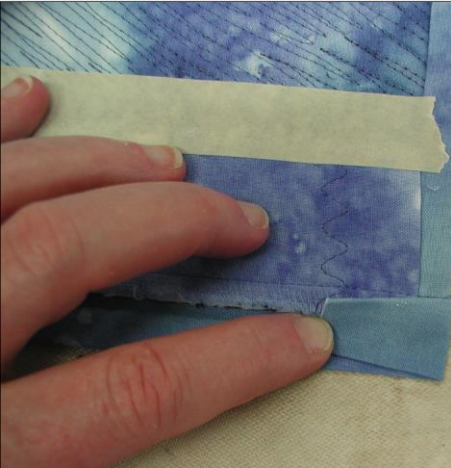

Make sure it forms
a straight line with
the right side of
the quilt...

BACK

NEXT

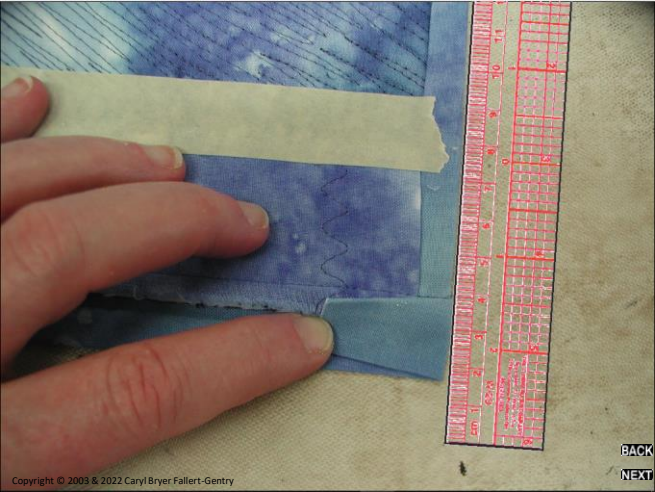

and iron.

BLACK

BACK

NEXT



Here it is after it
has been ironed.

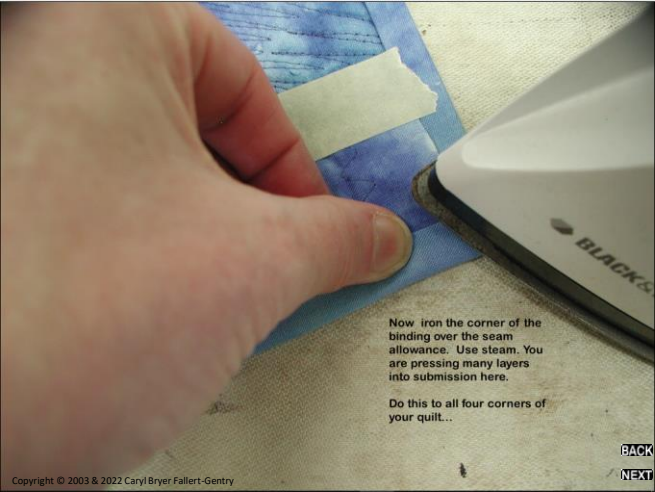

Now iron the corner of the binding over the seam allowance. Use steam. You are pressing many layers into submission here.

Do this to all four corners of your quilt...

[BACK](#)

[NEXT](#)

glue the seam allowance, iron, and you're ready to do the final stitching on your binding.



[BACK](#)

[NEXT](#)



Thread your machine with monofilament. In the bobbin use thread that matches the binding. You will need to change bobbin colors when the color of the binding changes.

Use the edge foot (Bernina #10), and stitch in the ditch on all four sides.

[BACK](#)

[NEXT](#)



Caryl Bryer Fallert

Sign your name with
contrasting thread.

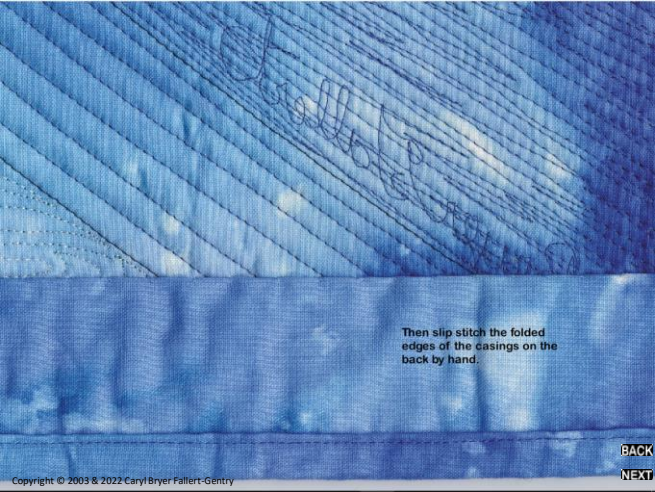

Then slip stitch the folded
edges of the casings on the
back by hand.

BACK

NEXT

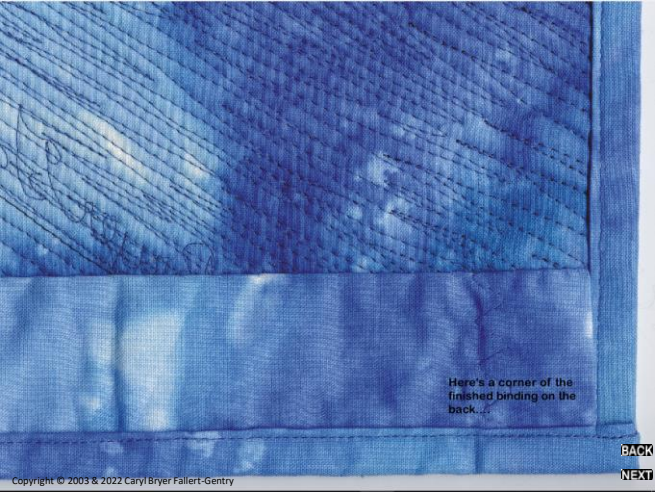

Here's a corner of the
finished binding on the
back...

BACK

NEXT

and here's another corner on the front.

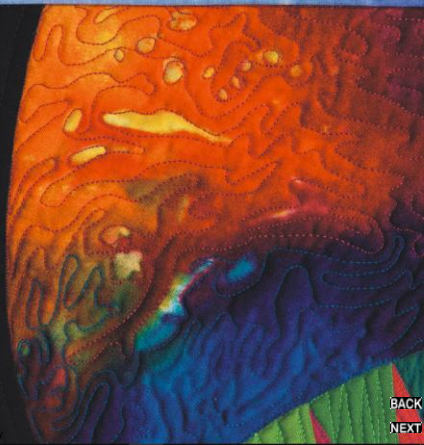

BACK

NEXT

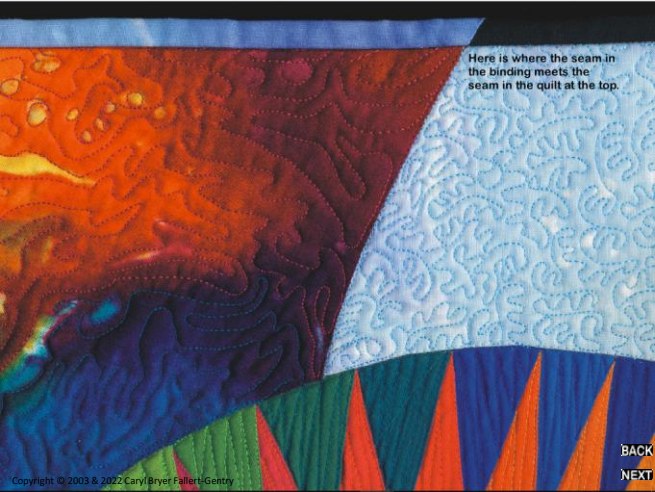

Here is where the seam in
the binding meets the
seam in the quilt at the top.

BACK

NEXT

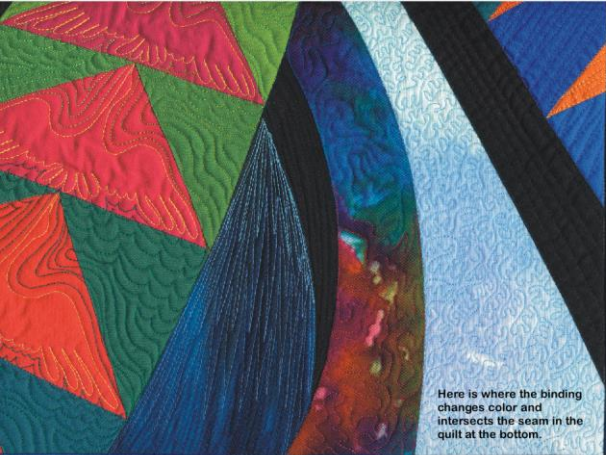

Here is where the binding
changes color and
intersects the seam in the
quilt at the bottom.



Soaring Compliments

24" x 24"

Copyright 2003 Caryl Bryer Fallert

To find more sets of free
instructions [CLICK HERE](#).
To see all of Caryl's work, go to
www.bryerpatch.com

BACK

NEXT